

Elizabethtown Business Center
48 S Market St. Elizabethtown, Pa 17022

Treehouse Counseling (Suite 203) & Linden Blossom Counseling (Suite 200)

When going South on Market street, our building will be on the right. Parking and Entrance are in the rear of the building.

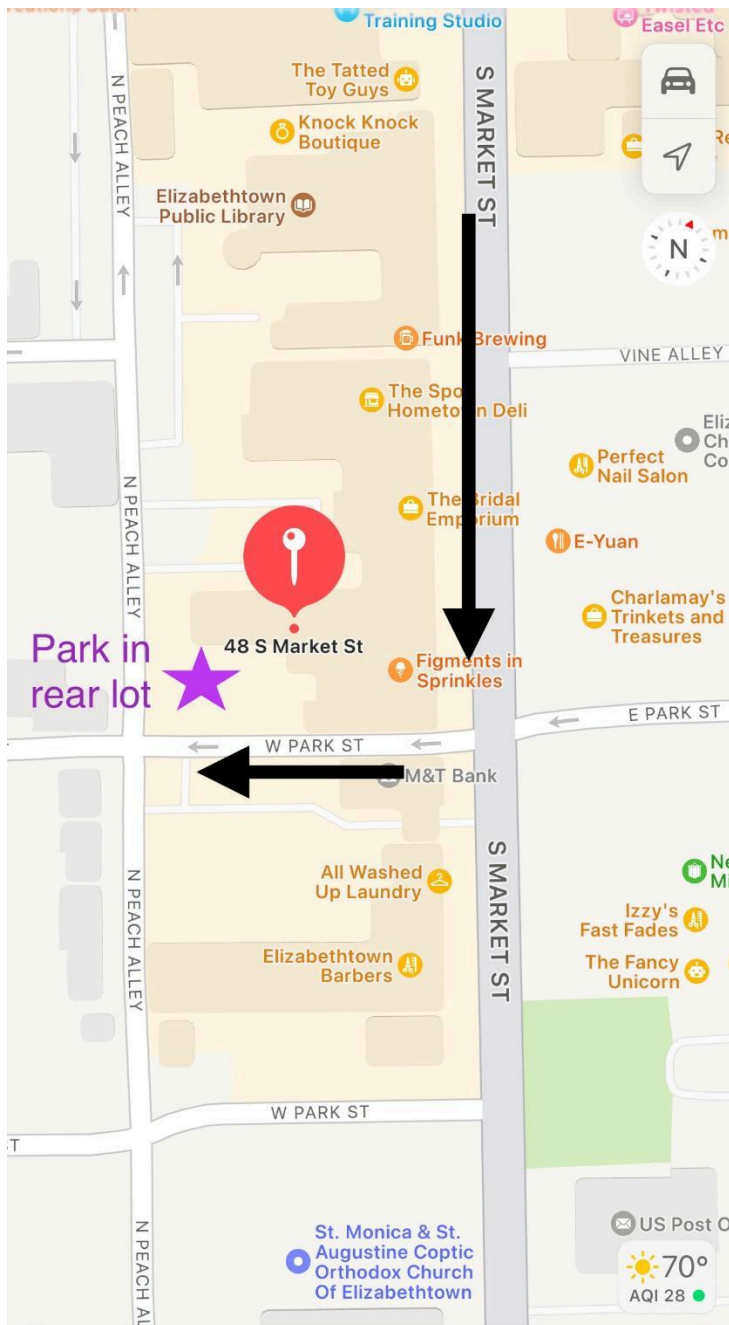

PARKING:

Turn onto W. Park Street just before the M&T Bank (street is one way and looks much like an alley).

Free parking is available in the lot along W Park St. and N. Peach Alley.

The entrance for the Counseling offices are located under the large awning of the long brick building. Unfortunately, there is a lack of signage in the back of our building. Look for a small homemade sign near the door and key pad.

Keypad Instructions for 48 S. Market Street

Treehouse Counseling and Linden Blossom Counseling

SAFETY FIRST! Our building is equipped with a security feature called ButterflyMX. This means that the building remains locked at all times. All visitors are required to utilize the touchscreen keypad intercom directory located by each door. There are two easy ways to gain access into the building: Virtual Key or Directory Call.

 ButterflyMX Butterfly MX – watch how it works!

<https://butterflymx.com/products/video-intercoms/>

VIRTUAL KEY

STEP 1: Your therapist will text or email you a link to a QR code. This code can be used as a virtual key to gain entrance into the waiting room.

STEP 2: Press the touchscreen of the keypad intercom to get started. Click on the square labeled “Virtual Key”

STEP 3:

Use your smart phone to display key (QR code) and line up the key with the intercom keypad. You will see a prompt to line up the key as shown below:

Pro tip: you *do not* have to click the ‘Virtual Key’ button on the intercom. You can just show your virtual key to the intercom, and if it’s valid, the door will open.

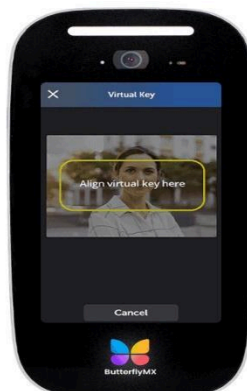

Once lined up correctly, they'll hear a chime and see a notification that the door is open.

DIRECTORY:

STEP 1: Tap the touchscreen to wake the video intercom. Click the directory button to bring up business names.

STEP 2: Search the directory for your therapist: Treehouse Counseling (Kate Warner or Karin Laszakovits) or Linden Blossom Counseling (Abbee Hanson).

STEP 3: Click “call” on the Therapist’s name-this will send a one-way video and audio call to the therapist. The therapist will either answer the call to confirm who is checking in or simply press “Open Door” to remotely open the door for you. The call then ends and you can enter the waiting room.

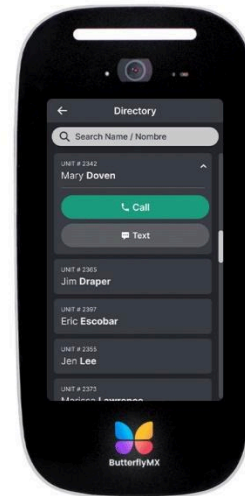

WELCOME to our new space! If you have any issues, please call or text your therapist directly.